

CABLE GLANDS

Appleton's ATX product line includes a wide selection of both **Increased Safety and Flameproof** cable glands for use with **unarmored and armored cable**.

Appleton's ATX cable glands are available in a wide range of materials from polyamide, nickel-plated brass and stainless steel to withstand any environment. Appleton's ATX cable glands are available with metric or NPT threads. Cable glands are certified for increased safety, flameproof, restricted breathing and dust applications.



Cable Glands

Description	Page
Introduction to Cable Glands	399
EEXe Series	400-401
Polyamide Cable Glands for Unarmored Cable – Increased Safety	
A2F, E1FX/E2FX, E1FW/E2FW and T3 Series	402-406
Nickel Plated Brass Cable Glands for Unarmored and Armored Cables with Elastomer Seal – Increased Safety and Flameproof	
PX and PX2K Series	407-409
Nickel Plated Brass Cable Glands for Unarmored and Armored Cables with Compound Barrier Seal – Increased Safety and Flameproof	
757, BVE and 737 Series	410-414
Blanking Plugs, Adaptors and Reducers – Increased Safety and Flameproof	
Accessories for Cable Entries	415-417
Nickel Plated Brass Locknuts	
Brass Earth Tag	
Entry Thread Seals	
316L Stainless Steel Serrated Washers	
PVC Shrouds	
Clamp for Lead Sheath Armored Cable Glands	
DB Series	418-425
Drain and Breather Valves	419
Fire Retardant Seals and IIC Elbows	420-421
IIC Flexible Couplings	422-423
IIB Unions – Flameproof	424-425

EEXe Series



A2F, E1FX/E2FX, E1FW/E2FW and T3 Series



PX and PX2K Series



757, BVE and 737 Series



Accessories



DB Series

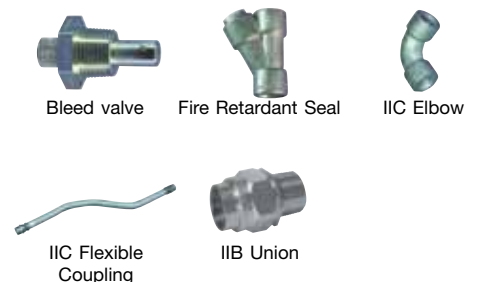

Cable Glands

EEXe Series: Polyamide Cable Glands for Unarmored Cable – Increased Safety



095756
Ex e Certified



095801
Weatherproof IP68
Ex i Certified Application



Entry Thread Seal

Compliance Data:

ATEX - IEC:



Zones 1 & 2, 21 & 22	ATEX	II 2 GD	IEC	CE
Ex e II	Ex tD A21	IP66 / 68		

Operating Temperatures:

-20°C to +55°C

CABLE GLANDS

Cable Glands

EEXe Series: Polyamide Cable Glands for Unarmored Cable – Increased Safety

Zone 1 & 2 – 21 & 22

II 2 GD

ATEX / IEC

IP66/68

Ex e Certified Applications:

- For unarmored cables certified for enclosures with the following protection modes:
 - Ex e increased safety.
 - Ex nR restricted breathing.
 - D dust environment.
- Hazardous areas (gas and dust).
- Onshore and offshore.

Features:

- Black polyamide body.
- Supplied with two polyamide clamping rings.
- Weatherproof elastomer gasket.
- Supplied with sealing gasket.

Materials:

- Body: Polyamide.
- Weatherproof gasket: thermoplastic elastomer.
- Entry thread seal: neoprene.

Weatherproof IP68 or Ex i

Certified Applications:

- For unarmored cables for intrinsic safety Ex i applications in hazardous areas (Gas and Dust).

Features:

- Blue polyamide body Ral 5012.
- Supplied with polyamide clamping ring.
- Weatherproof elastomer gasket.
- Supplied with sealing gasket.

Materials:

- Body: polyamide.
- Weatherproof gasket: thermoplastic elastomer.
- Entry thread seal: neoprene.

Dimensions (mm):

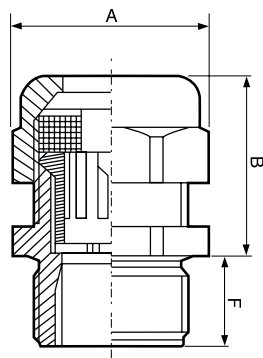

Ordering Information:



Ex e Certified

Thread	Cable Capacity (mm)		Dim. Flat A (mm)	Length B (mm)	F (mm)	Weight (Kg)	Volume (dm ³)	Catalog Number	Pack
	Min.	Max.							
M16	3.0	8.5	19.0	24.0	15.0	0.015	0.160	095756	10
M20	6.5	14.5	27.0	30.0	15.0	0.021	0.160	095605	10
M25	8.0	18.5	33.0	33.0	15.0	0.032	0.160	095606	10
M32	10.0	25.0	42.0	43.0	15.0	0.061	0.440	095757	10
M40	24.0	34.0	55.0	47.0	15.0	0.072	0.720	095758	1
M50	28.0	42.0	65.0	49.0	15.0	0.124	0.720	095759	1



Weatherproof IP68

Thread	Cable Capacity (mm)		Dim. Flat A (mm)	Length B (mm)	F (mm)	Weight (Kg)	Volume (dm ³)	Catalog Number	Pack
	Min.	Max.							
M16	2.5	8.0	19.0	27.0	15.0	0.013	0.160	095800	10
M20	5.0	12.0	24.0	30.0	15.0	0.017	0.160	095801	10
M25	7.0	14.0	27.0	35.0	15.0	0.020	0.160	095802	10
M32	14.0	25.0	42.0	42.0	15.0	0.051	0.440	095803	10
M40	18.0	32.0	53.0	52.0	16.0	0.072	0.720	095804	1
M50	24.0	38.5	60.0	55.0	16.0	0.100	0.720	095805	1

Accessories: (Locknut - see accessories section)

Compliances:

Hazardous Area	Gas	Dust
Certification Type	EEXe	
Zones	1-2, 21-22	
Conforming to 94/9/CE ATEX	II 2 GD	
Symbol of Protection ATEX	Ex e II	Ex tD A21
Symbol of Protection IEC		
T Rating	/	
Surface Temperature	N.A.	
Ambient Temperature	-20°C to +55°C	
CE Declaration of Conformity	50233	
ATEX Certificate	LCIE 99 ATEX 6030X	
Index of Protection (solid and liquid)	IP66 (Ex e version), IP68 (Weatherproof version)	

Standards:

Ex Standards	EN / IEC 60079-0; 60079-7; 61241-0; 61241-1
Product Standards	/
Other Standards	ISO 065/I/III (metric thread), EN / IEC 60529